

PRINCIPLE OF ENERGY STORAGE COMBINER CABINET

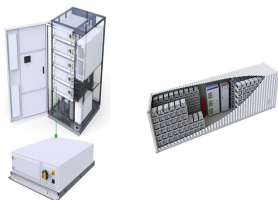

What is DC-coupled and AC-coupled PV & energy storage? This document examines DC-Coupled and AC-Coupled PV and energy storage solutions and provides best practices for their deployment. In a PV system with AC-Coupled storage, the PV array and the battery storage system each have their own inverter, with the two tied together on the AC side.

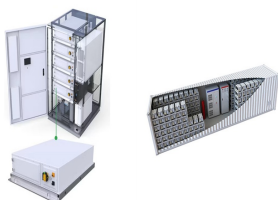

What is a acs-500 AC-coupled energy storage system? The ACS-500 AC-Coupled energy storage system is an excellent choice for new projects that don't include PV, for existing PV plants that want to add energy storage capabilities without disturbing the existing inverters, and for projects where the batteries cannot be easily collocated near the PV inverters.

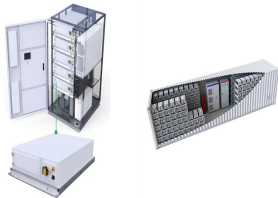

What is a PV system with AC-coupled storage? In a PV system with AC-Coupled storage, the PV array and the battery storage system each have their own inverter, with the two systems tied together on the AC side. The two systems are thus electrically separated, allowing a customer to size each separately.

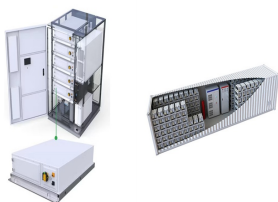

Does Yaskawa offer a battery energy storage system? 8 . W H AT Y A S K A W A Yaskawa offers two different 500kW systems for battery energy storage, the PVS-500 for battery storage DC-Coupled with a PV array, and the ACS-500 for battery containers.

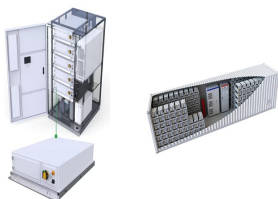

How does a DC re-combiner work? The DC-Coupled system???s dedicated DC re-combiner has a number (here 5) of DC inputs that matches the maximum number of combiner boxes that can be connected to it. It has a second type of fused input connection that connects to the DC/ DC converter and a fused output that connects to the inverters.

PRINCIPLE OF ENERGY STORAGE COMBINER CABINET

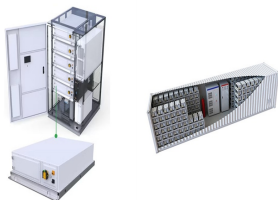

What are the different types of energy storage systems? Hence, a popular strategy is to develop advanced energy storage devices for delivering energy on demand. 1 - 5 Currently, energy storage systems are available for various large-scale applications and are classified into four types: mechanical, chemical, electrical, and electrochemical, 1, 2, 6 - 8 as shown in Figure 1.

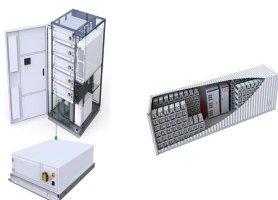

6 ? Each component in a capacitor cabinet plays a vital role in ensuring that electrical systems are efficient, safe, and reliable. By integrating such advanced technology, Eabel's capacitor cabinets are at the forefront of energy management solutions, driving industries towards more sustainable practices. The Principle of Eabel's Capacitor



The energy storage system consists of battery, battery management system, energy management system, combiner cabinet, bidirectional converter, lighting system, fire alarm system, temperature management system, monitoring system, etc. The battery system is connected to the solar storage and charging integrated machine.



The combiner box is an important component of the photovoltaic power generation system. Its main function is to combine and distribute the direct current generated by the photovoltaic modules for subsequent connection to the inverter or other equipment. The combiner box is usually installed below the photovoltaic modules and connected to the photovoltaic modules ???



An energy storage transformer is a specialized transformer designed for use in energy storage systems, operating on a principle similar to standard transformers. Its primary function is to adjust the voltage and current within energy storage systems to ???

PRINCIPLE OF ENERGY STORAGE

COMBINER CABINET

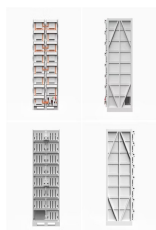

Product Overview. Adopting the design concept of "unity of knowledge and action", integrating long-life LFP batteries, BMS, high-performance PCS, active safety systems, intelligent distribution systems, and thermal management systems into a single standardized outdoor cabinet, forming an integrated and pluggable smart energy source product ERAY Energy Source, highly ???



Hentong Energy's lithium iron phosphate high-voltage DC energy storage system is mainly used in energy storage applications such as new energy generation side, user side, power grid side, and shared energy storage. The system scheme is designed based on a single energy storage unit of 1.86MW/3.72MWh, using an outdoor cabinet structure layout and a DC side maximum ???



Energy storage can be defined as the process in which we store the energy that was produced all at once. cabinets, or other storage. These chemicals can be hazardous or non-hazardous. For the current energy generation system, these storages will be in the form of biomass, coal, and gas. The four principles of thermodynamics regulate the



A common question among energy storage installers is how to properly combine multiple battery cabinets in a solar-plus-storage system. While smaller systems, those with one or two cabinets and one inverter, are fairly straightforward to install, larger solar-plus-storage systems are more complex. Larger systems, particularly those with more



The role of the combiner box is to bring the output of several solar strings together. Daniel Sherwood, director of product management at SolarBOS, explained that each string conductor lands on a fuse terminal and the output of the fused inputs are combined onto a single conductor that connects the box to the inverter."This is a combiner box at its most basic, ???

PRINCIPLE OF ENERGY STORAGE COMBINER CABINET



4 UTILITY SCALE BATTERY ENERGY STORAGE SYSTEM (BESS)
BESS DESIGN IEC - 4.0 MWH SYSTEM DESIGN This documentation provides a Reference Architecture for power distribution and conversion ??? and energy and assets monitoring ??? for a utility-scale battery energy storage system (BESS). It is intended to be used together with

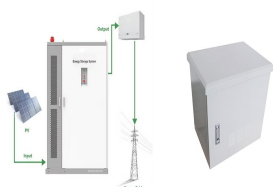

primarily energy capacity driven, at an optimal life-cycle cost ENERGY STORAGE kongsberg 34.PropSyst-1 of 2-18.11.20 The demand for green solutions in the maritime industry is driving an increased use of clean electrical power systems that utilise energy storage. The energy storage unit from Kongsberg Maritime is specifically



The Smart Energy Storage Integrated Cabinet is an integrated energy storage solution widely used in power systems, industrial, and commercial applications. This cabinet integrates advanced battery technology, energy management systems, and intelligent controls, achieving efficient energy storage in a compact device.



Heat storage techniques are going to be discussed in the following sections, along with hybrid heat storage systems that combine sensible and latent heat storage methods. In a number of sources, heat storage methods are divided into three categories: sensible, latent, and thermochemical. 2.4.3 Working Principles of Thermal Energy Storage



This way, people can make the most of the available solar energy and use it for residential or commercial purposes. Each string conductor lands on the terminal of fuses, and the output of the fused inputs is brought together in a single conductor where the box is ???

PRINCIPLE OF ENERGY STORAGE COMBINER CABINET



Study on strategy of wind farm combined with distributed energy storage
 ??? The frequency support control principle of DFIGs based on variable proportional speed regulation to achieve MPPT operation mode is shown in Fig. 1, where P_s is the output power of DFIG, ω_r is the WT rotor speed, k is the proportional speed regulation coefficient, $\omega_{r\text{ref}}$, T_{ref} and $P_{s\text{ref}}$ are the ???



Combiner box means that the user can connect a certain number of PV cells with the same specifications in series to form one PV series, and then connect several PV series in parallel to the PV combiner box. inverter, DC power distribution cabinet, PV inverter, and AC power distribution cabinet are used together to form a complete PV power generation system, which ???



The "Energy Storage Medium" corresponds to any energy storage technology, including the energy conversion subsystem. For instance, a Battery Energy Storage Medium, as illustrated in Fig. 1, consists of batteries and a battery management system (BMS) which monitors and controls the charging and discharging processes of . ?????????? ???(R)???????????



All-in-one energy storage systems are innovative solutions that combine multiple components of solar power generation and storage into one cohesive unit. These systems typically include solar panels, a battery pack, an inverter, and sometimes a charge controller, all integrated into a single, manageable system. To better understand the



Key Features of Battery Cabinet Systems. High Efficiency and Modularity: Modern battery cabinet systems, such as those from CHAM Battery, offer intelligent liquid cooling to maintain optimal operating temperatures, enhancing the system's lifespan by up to 30%. They also support grid-connected and off-grid switching, providing flexibility in energy management .

PRINCIPLE OF ENERGY STORAGE COMBINER CABINET

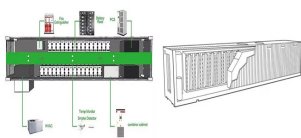

Understanding Energy Storage Cabinets. Energy storage cabinets are integral components in modern power solutions. They provide a safe and efficient way to store energy for later use. Typically, these cabinets are designed to house batteries or other energy storage devices that capture and retain energy. This stored energy can be utilized during



Company Since 1998 Industrial / Commercial Energy Storage System
Application: EMS system, Interchanger, Monitoring Software, UPS, Solar system, etc. Technology: LithiumIron Phosphate (LiFePO₄) Voltage: 716.8V -614.4V-768V-1228.8V Capacity: 280Ah Cycle life: ??? 6000 times Operation Temp: -20°C~ 60°C Customizable batteries: voltage, capacity, appearance, ???

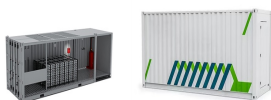

These innovative systems combine various technologies within a single cabinet, offering a compact and efficient solution for energy storage needs. This article explores the integrated technologies within Cabinet Energy Storage systems, shedding light on their significance, applications, and the transformative impact they hold on the energy



LiHub All-in-One Industrial and Commercial Energy Storage System is a beautifully designed, turn-key solution energy storage system. Within the IP54 protected cabinet consists of built-in energy storage batteries, PCS inverter, BMS, air-conditioning units, and double layer fire protection system.

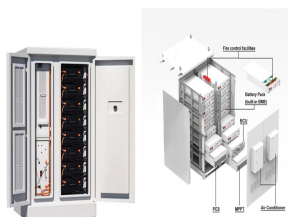

Base-type Energy Storage Cabinet. Base-type energy storage cabinets are typically used for industrial and large-scale applications, providing robust and high-capacity storage solutions. Integrated Energy Storage Container. Integrated energy storage containers combine energy storage with other essential systems, such as cooling and control

PRINCIPLE OF ENERGY STORAGE COMBINER CABINET



Catl C& I Cabinet Energy Storage System product introduction of cell, module, high voltage box, outdoor battery cabinet, Outdoor Combiner cabinet. Welcome To Evlithium Best Store For Lithium Iron Phosphate (LiFePO₄) Battery