

RADIO AND TELEVISION NETWORK

ENTERPRISE WECHAT

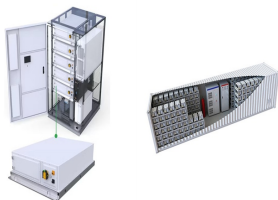

What is Enterprise WeChat? Technical background Enterprise WeChat is an office collaboration product, and chat messaging is the most basic function. The stability, reliability, and security of the message system are especially important. There are many difficulties in the construction and design of the message system.

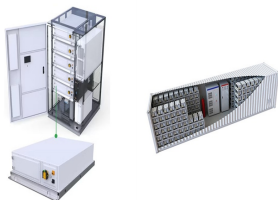

What is WeChat work? WeChat Work Users are able to post on WeChat Moments of their personal account in order to communicate between employees and manage customers. 5. Feature updates and timeline on WeChat Enterprise platform Deploy your company Wechat Pay QR code to all your employee with one click.

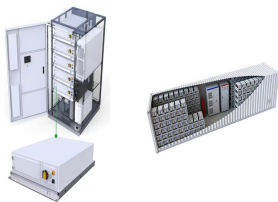

What is the IM messaging architecture of Enterprise WeChat? Thinking and summarizing The IM messaging architecture of enterprise WeChat is similar to that of WeChat, but it faces some new challenges in the to B business scenario. Combining the product form, analysis strategy, and optimizing the plan to ensure the reliability, stability, and security of the message system.

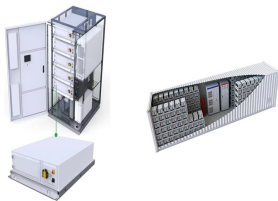

Is WeChat a personal app? Leveraging the experience from WeChat super APP for personal purposes, Tencent has developed an Enterprise set of tools for team collaboration, management, and communication with the idea of overcoming the drawbacks of using personal software at work. WeChat at Work or WeChat Work, formerly WeChat Enterprise Accounts, is now a separate app.

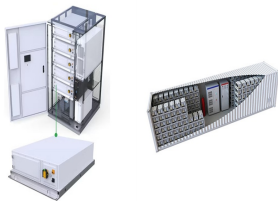

How to use WeChat corporate? Deploy your company Wechat Pay QR code to all your employee with one click. For sales team: employees can now individually collect payments from customers, deposit directly into your company account. 6. News and timeline on WeChat Corporate the current tool is mainly used for internal company communication.

RADIO AND TELEVISION NETWORK ENTERPRISE WECHAT

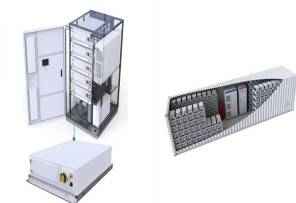

What is a WeChat official account? For example, positioning the Subscription Account as the source for official news and mainly to serve potential customers, while the Service Account is positioned as the one stop for all brand-related services. WeChat Official Accounts are great ways to build brand awareness and connect with your customers.

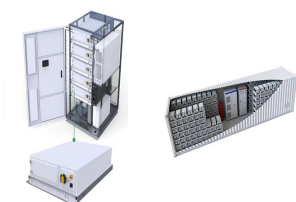

According to Tencent, there are four types of WeChat Official Accounts (also known as "OA"), which include Service Account, Subscription account, WeChat Work (Formerly "Enterprise Account"), and Mini Program. ???



on the basis of traditional media such as newspapers, radio, television, leaflets and pictorial newspapers. It is a media form based on electronic technology, Internet technology, big data and



Radio and TV upload: License for Radio and TV Broadcasting Institution or License for Broadcast and TV Channel. Newspaper Publication License of the People's Republic of China. Journal ???



What will enterprise management look like in a country that is both massive and has overwhelmingly mobile-first in behavior? We have seen big differences in consumer China because of these differences. But how will they ???

RADIO AND TELEVISION NETWORK ENTERPRISE WECHAT



Scholars have extensively examined how people use mass media such as television, radio, newspapers and the like is associated with various gratification (Rubin & Perse, 1987). Later this line



Here are the 6 key takeaways about WeCom (WeChat Work) for brands operating in China to keep in mind: WeCom is a professional and corporate version of WeChat that is strongly tied to the WeChat ecosystem. WeCom addresses WeChat's weakness in CRM and helps protect brands' ownership of their customer contact databases.



The reliability of WeChat, Weibo, network news and information, newspapers, radio and TV news was at 63.4, 38.6, 21.7, 19.6, 14.6 and 33.9% respectively (see Fig. 2.1). Fig. 2.1 Trustworthiness of news on different media platforms



video platforms "quick hand" and the heads of today's headline "Volcano Video" accepted the network letter office interview, and some of the misguided, low-profile client software, WeChat public account, and network audio-visual program were ordered to shut down by the State Administration of Radio and Television.



WeChat Enterprise Account (also known as WeChat Work): for business internal use. Mini Programs: for developing apps and software. Since WeChat Enterprise Account is used primarily for internal communication and management, Service Account is recommended for businesses to reach out to customers.

RADIO AND TELEVISION NETWORK

ENTERPRISE WECHAT



According to the news from this site on January 15, according to official news from the "China Radio and Television 5G" public account, the 192 number of China Radio and Television has now launched a WeChat low-amount automatic recharge service to avoid sudden arrears and shutdown problems. After the unified account is bound, cable TV bills can be paid ???

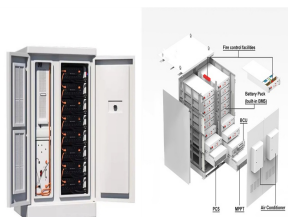

which are enterprise accounts. WeChat official accounts supply a good chance to government departments, enterprises, media and personal to propagandize and popularize their information. Secondly, traditional media, including radio and television, newspapers and magazines such as People's Daily, CCTV News, and Southern Weekly etc.; Thirdly



on the basis of traditional media such as newspapers, radio, television, leaflets and pictorial newspapers. It is a media form based on electronic technology, Internet technology, big data and



Guangxi Radio and Television Information Network Corporation Limited is a China-based company principally involved in digital TV business. The Company's main businesses include radio and television transmission and service business, information technology development and service business and network value-added service business, ???



In 2020, China's powerful media regulator, the National Radio and Television Administration (NRTA), began formally including short dramas ??? which it defined as programs with episodes of less than 10 minutes ??? under its supervision. This year, 2023, is believed to be the first hugely profitable year for micro-dramas in the Chinese market.

RADIO AND TELEVISION NETWORK ENTERPRISE WECHAT



"WeChat Mars: The network layer packaging library being used inside WeChat, will be open source soon" Enterprise WeChat adopts a solution to achieve it, which is simple and reliable, with minor changes: the problem of storage redundancy can be merged through LevelDB when the disk is placed, and only the message of the final state can be



The separation of production and dissemination became a hot word again in 2014. This has been growing in China for over ten years. While seeking technology upgrades, platform development and content innovation, radio and television organizations at all levels, especially several television channels, have trialed the separation of production and ???



Today WeChat launched its anticipated work chat app, WeChat Enterprise, set to directly compete with the likes of Slack, which is probably the most popular office chat app to date. Recommended Videos

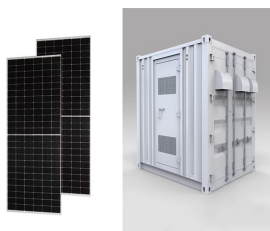

At the seminar on 700MHz technology and industrial application held today, Zeng Qingjun, deputy general manager of China Radio and television network Co., Ltd., said: how can China Radio and television avoid homogeneous competition and form differentiated development with the three traditional operators? The breakthrough point found by China ???



WeChat or Weixin in Chinese (Chinese: 微信; pinyin: Wēixìn (listen ???); lit. "micro-message") [a] is a Chinese instant messaging, social media, and mobile payment app developed by Tencent rst released in 2011, it became the world's largest standalone mobile app in 2018 [5] [6] with over 1 billion monthly active users. [7] [8] [9] WeChat has been described as China's "app ???

RADIO AND TELEVISION NETWORK

ENTERPRISE WECHAT



Tianjin Renmin Guangbo Diantai (Chinese: ; pinyin: Tiānjīnguāngbō Diàntái), translated as the Tianjin People's Broadcasting Station (TPBS) is a major radio broadcaster in Tianjin, China. They also operate the Tianjin Television station, also known as TJTV. Tianjin Television (TJTV) (Chinese: ; pinyin: Tiānjīnguān Diànshìtān) is a



Radio and Television Business Report (RBR-TVBR), is focused on the business side of the radio and television industry, offering deep financial and regulatory coverage. RBR-TVBR Follows the money



In April 2016, the Chinese tech giant Tencent made an ambitious foray into the enterprise market by launching WeChat Work, an enterprise social network app adopted from its immensely popular consumer app WeChat. To increase WeChat Work adoption, Tencent leveraged on the 1-billion user base of WeChat and its strong consumer IT capabilities.

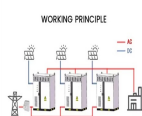

Radio and TV upload: License for Radio and TV Broadcasting Institution or License for Broadcast and TV Channel and the WeChat application account will not be released. The account type is the WeChat application number of the enterprise, and most of the initial development and management capabilities can be obtained after completing the



Widespread use of WeChat, a censored Chinese social-media platform, is helping it shut out those that are not. China's main spending on propaganda abroad has been on the foreign-language news

RADIO AND TELEVISION NETWORK ENTERPRISE WECHAT



During the Great Depression, radio became so successful that another network, the Mutual Broadcasting Network, began in 1934 to compete with NBC's Red and Blue networks and the CBS network, creating a total of four national networks ???

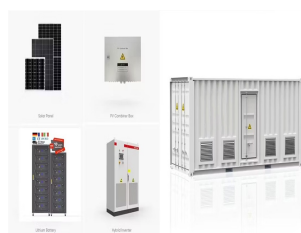

WeChat moments. WeCom has enabled of WeChat moments which can post promotional information, product dynamics, professional knowledge and other content to customers" WeChat moments, and interact ???